

LOOSE STEEL FLANGE

FOR STUB ENDS
EN POLYETHYLENE;
PN 10, PN 16 AS PER EN1092-1

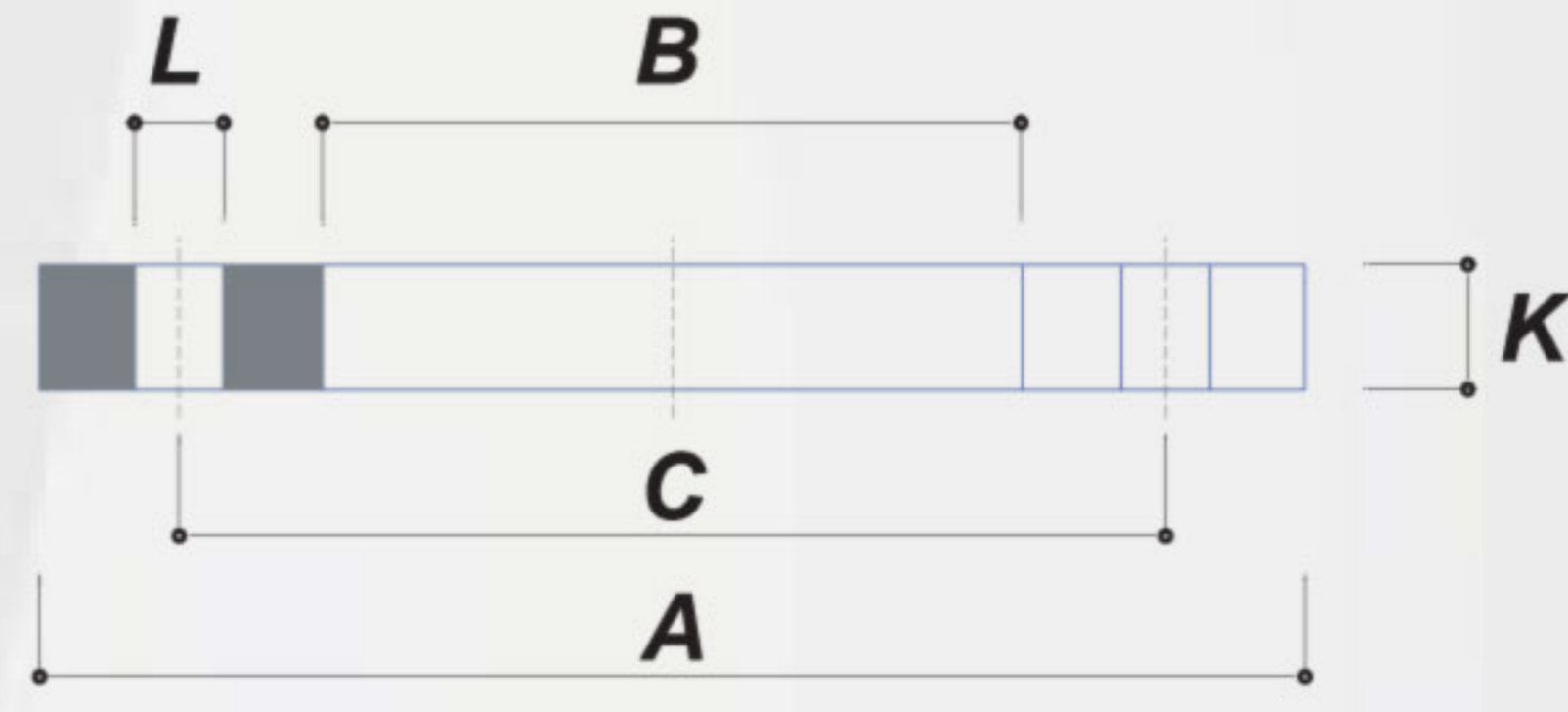

BLIND STEEL FLANGE

PN 10, PN 16 AS PER EN1092-1

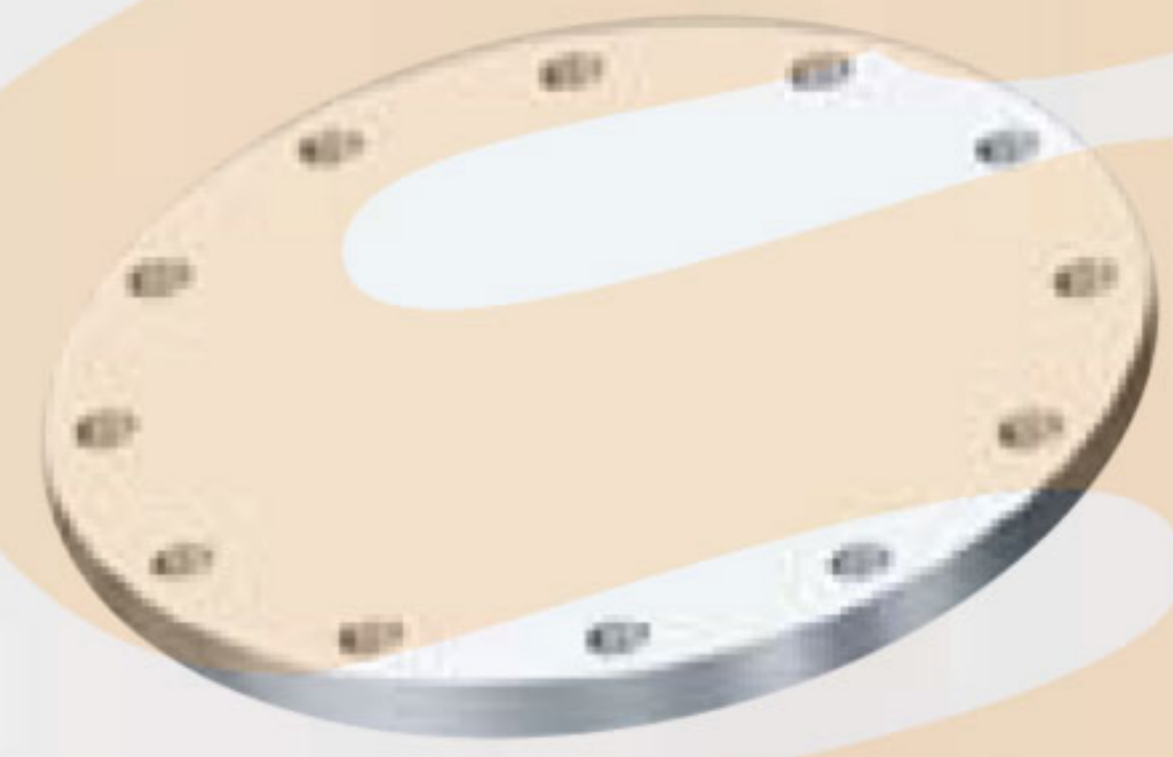
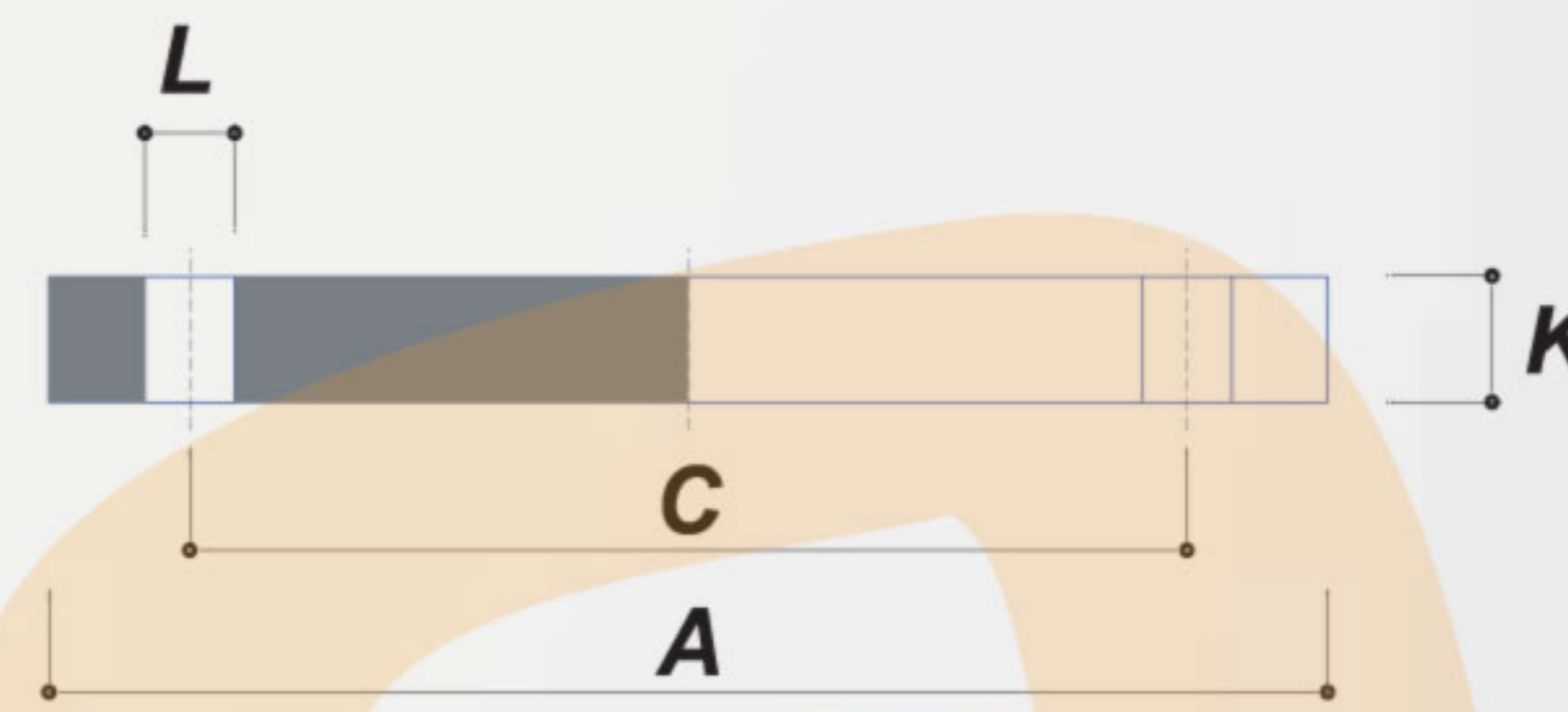

LOOSE ALUMINIUM FLANGE

FOR STUB ENDS EN POLYETHYLENE;
PN 10, PN 16 AS PER EN1092-1

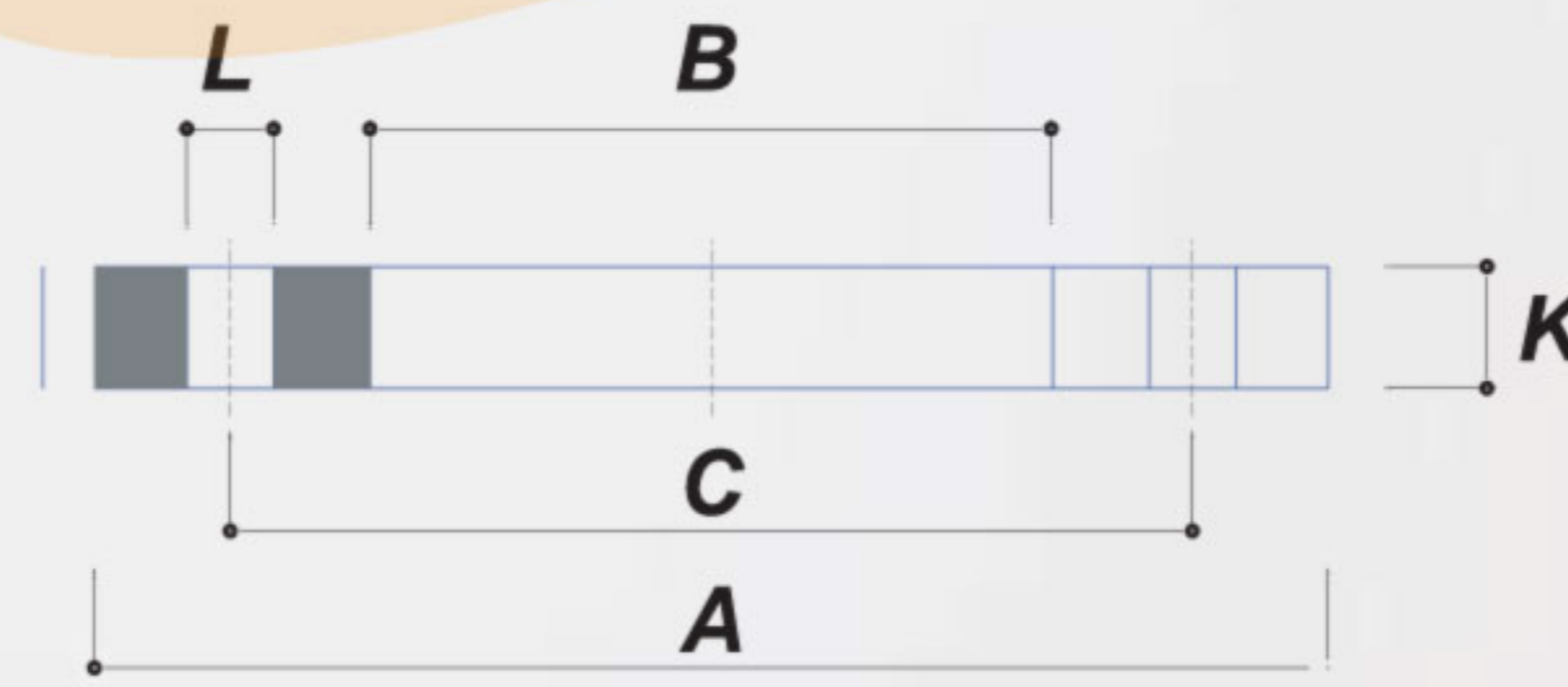

LOOSE PP/STEEL FLANGE

FOR STUB ENDS EN POLYETHYLENE;
PN 10, PN 16 AS PER EN1092-1

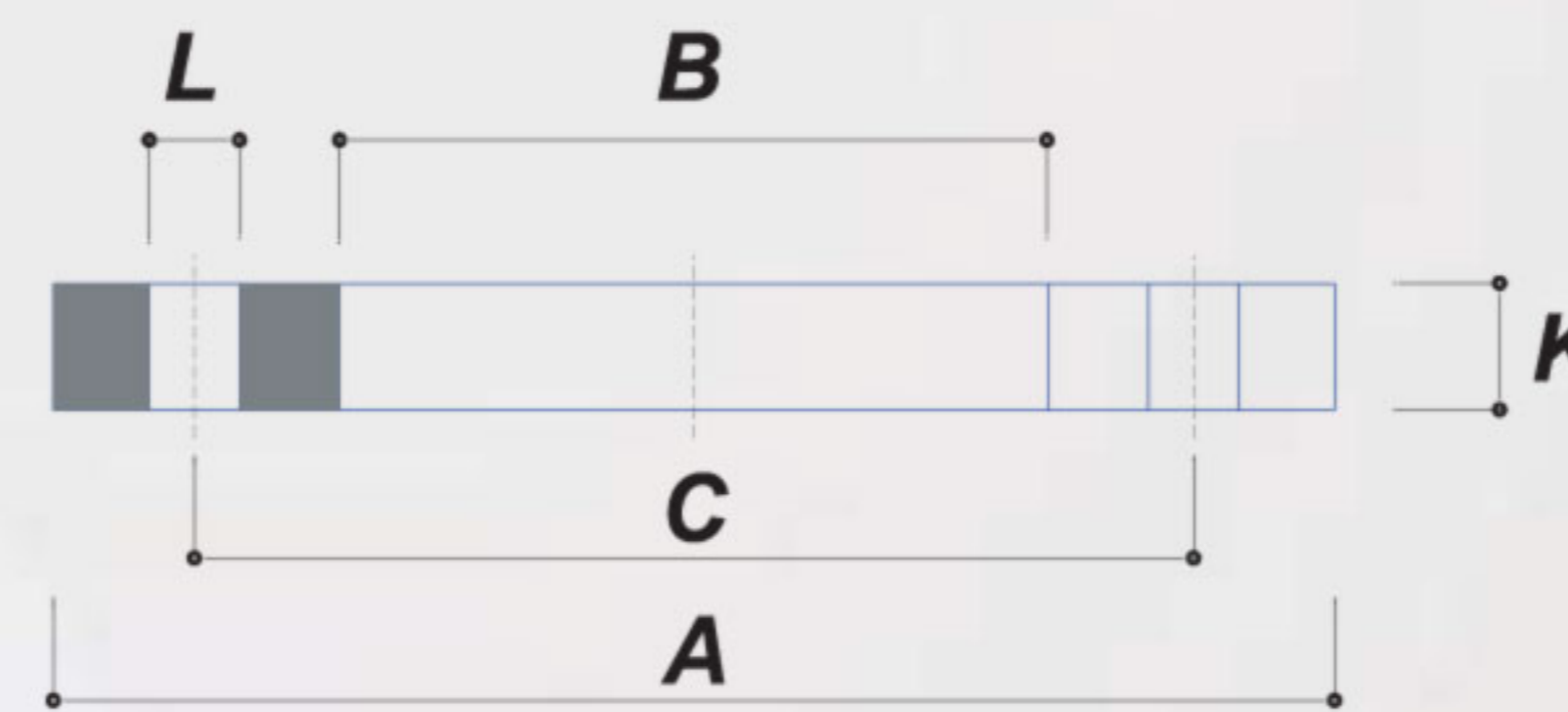

GASKET

